

## 14 Tail Unit Assembly

Secure the tail rotor hub(#11) on tail rotor shaft first, note the Set Screw(#3) should be right setting on the dot of the shaft. Do not forget to apply Loctite on the Set Screws. Do not over tighten the locknut(#4) with the two bearings. Next work on the housing assembly, use care to install the Tail Pitch Control Link, do not over tighten the selftapping Screw(#2). Make sure it is just tight and the link rotates freely. Assemble the Tail Pitch Slider and Fork. Be careful when securing the Fork on the slider bushing, do not damage the bushing or it will not move smoothly on the tail rotor shaft.

- |   |   |
|---|---|
| (1)HMC2510B Socket Screw(M2.5x10).....          | 4 |
| (2)HSE2-10B Selftapping Screw(M2x10)....        | 2 |
| (3)HME3-18.5B Set Screw(M3x18.5).....           | 2 |
| (4)HMM3Z Lock Nut(M3).....                      | 2 |
| (5)HMV1050ZZO Angular Bearing(d5xD10x4)...      | 4 |
| (6)HMV1060ZZY Bearing(d6xD10xW3).....           | 2 |
| (7)BK0082 Collar(d2xD3xW4.3).....               | 2 |
| (8)BK0546 Pin(2mm).....                         | 2 |
| (9)BK0302-1 Tail Pitch Housing(A).....          | 2 |
| (10)BK0303-1 Tail Pitch Housing(B).....         | 2 |
| (11)BK0307 Tail Rotor Hub.....                  | 1 |
| (12)BK0026 Tail Pitch Control Link.....         | 2 |
| (13)BK0025 Tail Pitch Control Fork.....         | 1 |
| (14)BK0027 Tail Pitch Control Slider.....       | 1 |
| (15)BK0028 Tail Pitch Control Slide Bushing.... | 1 |
| (16)BK0053 Tail Rotor Shaft.....                | 1 |
| (17)HMM25 Lock Nut(M2.5).....                   | 4 |
| (18)BK0075 Link Ball.....                       | 1 |
| (19)HMF2-8N Screw(M2x8).....                    | 1 |
| (20)HMS15 E Ring.....                           | 4 |

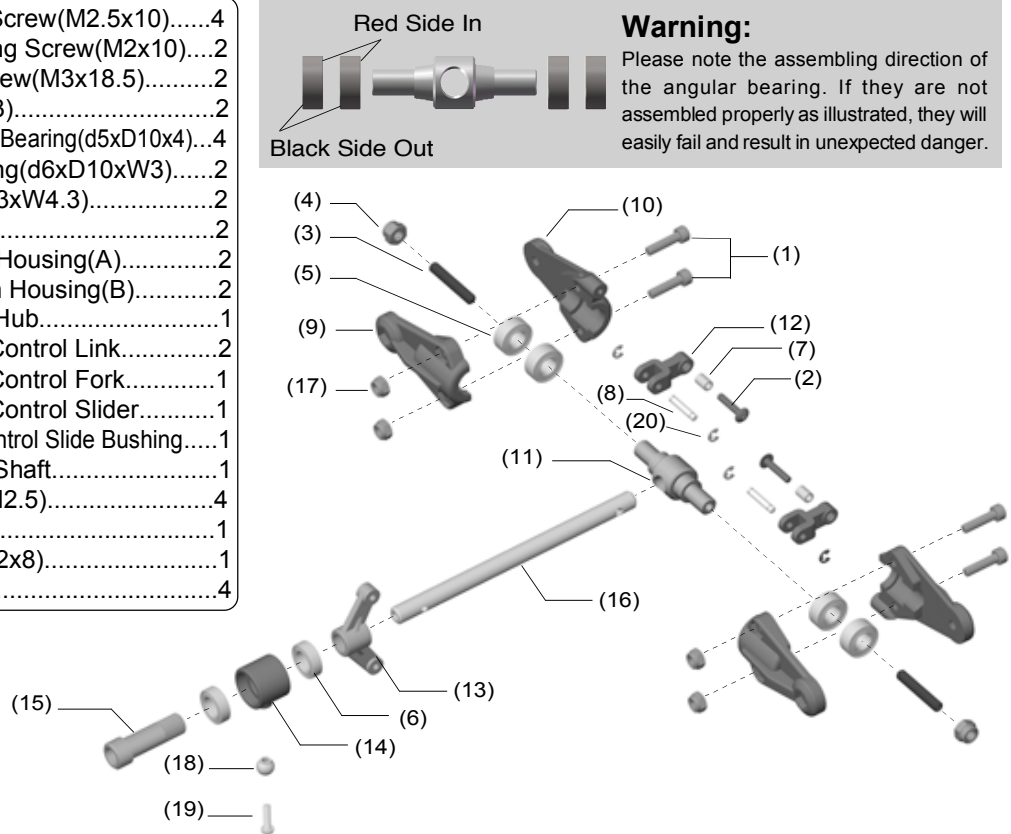

## 15 Tail Unit Assembly

Secure the Pulley by pressing the pin into the tail rotor shaft. Apply Loctite on set screw then secure the pin with the set screw in place firmly. Secure the Tail Pitch Control Lever just tight and make sure it rotates freely.

- |   |   |
|---|---|
| (1) HMV1150X Bearing (d5xD11xW5).....       | 1 |
| (2) HMY2-12 Pin(2x12).....                  | 1 |
| (3) HSE3-18B Self Tapping Screw(M3x18)..... | 1 |
| (4) HMF2-8N Screw(M2x8).....                | 1 |
| (5) BK0076 Collar(3x4x10).....              | 1 |
| (6) BK0075 Link Ball.....                   | 1 |
| (7) HMV740ZZY Bearing (d4xD7xW2.5).....     | 2 |
| (8) BK0024 Tail Pitch Control Lever.....    | 1 |
| (9) BK0088 Flat Washer.....                 | 1 |
| (10) HME3-4B Set Screw(M3x4).....           | 1 |
| (11) BK0050 Tail Pulley.....                | 1 |
| (12) BK0051 Tail Pulley Flange.....         | 1 |
| (13) BK0047 Tail Unit Housing (R).....      | 1 |
| (14) Tail Unit Assembly                     |   |

