

Apply a little amount of T43 thread lock when fixing a metal part.  
 螺絲鎖附於金屬件請使用適量T43 (螺絲膠)

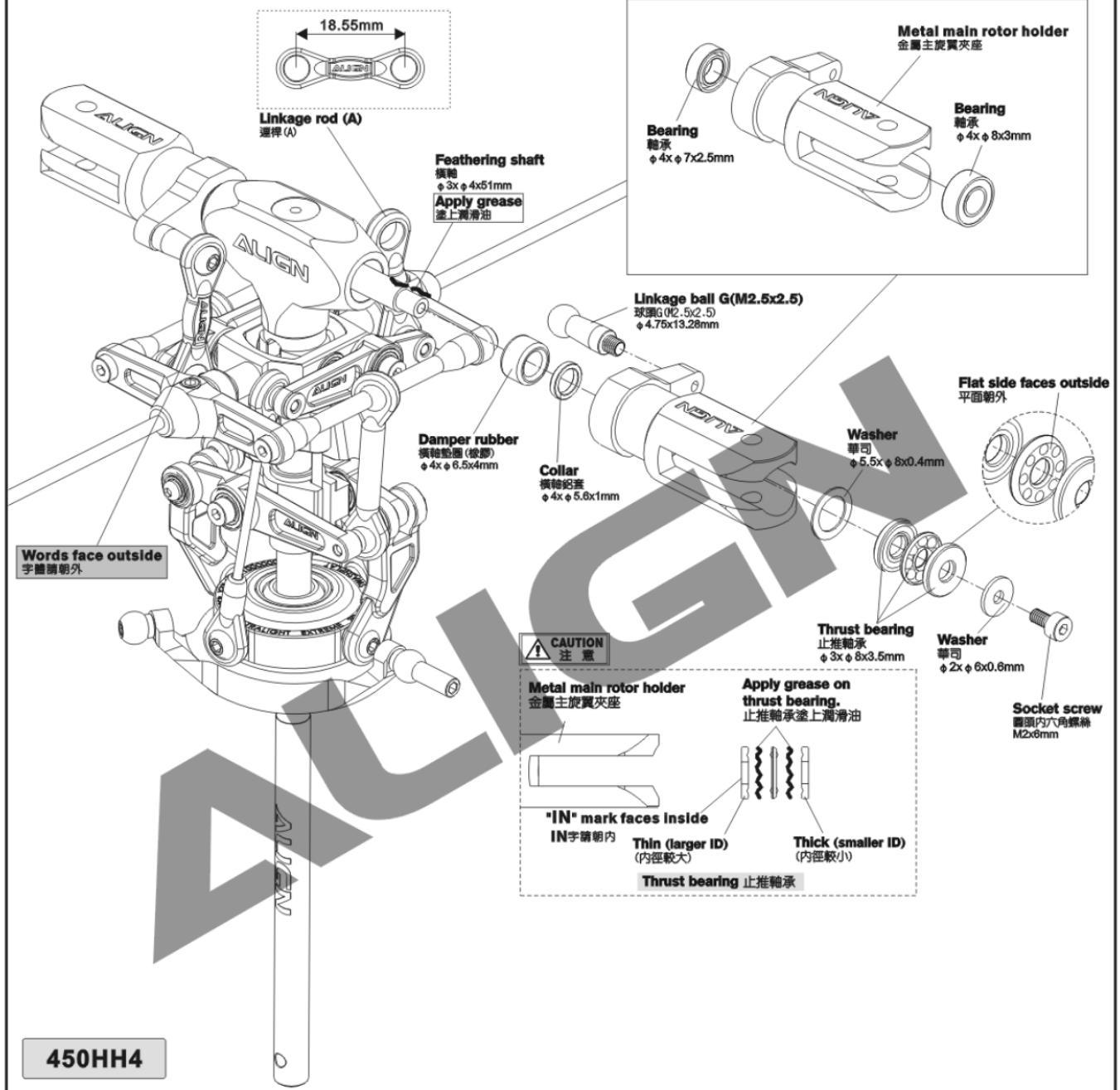

**450HH4**

- |   |  |   |   |   |
|---|--|---|---|---|
|   |  |   |   |   |
| <b>Linkage ball G(M2.5x2.5)</b><br>球頭G (M2.5x2.5) ( $\phi 4.75 \times 13.28\text{mm}$ ) x 2 | <b>Bearing</b><br>軸承 ( $\phi 4 \times 7 \times 2.5\text{mm}$ ) x 2 | <b>Washer</b><br>華司 ( $\phi 5.5 \times 8 \times 0.4\text{mm}$ ) x 2 | <b>Socket screw</b><br>圓頭內六角螺絲 (M2x8mm) x 2                         | <b>Damper rubber</b><br>橫軸墊圈 (橡膠) ( $\phi 4 \times 6.5 \times 4\text{mm}$ ) x 2 |
|   |  |   |   |   |
| <b>Thrust bearing</b><br>止推軸承 ( $\phi 3 \times 8 \times 3.5\text{mm}$ ) x 2                 | <b>Bearing</b><br>軸承 ( $\phi 4 \times 8 \times 3\text{mm}$ ) x 2   | <b>Washer</b><br>華司 ( $\phi 2 \times 6 \times 0.8\text{mm}$ ) x 2   | <b>Collar</b><br>橫軸鉗套 ( $\phi 4 \times 5.8 \times 1\text{mm}$ ) x 2 |   |

**450HZ6A**

- |                                      |
|--------------------------------------|
|                                      |
| <b>Linkage rod (A)</b><br>連桿 (A) x 2 |

**CAUTION 注意**

When tightening a screw to a plastic part, please tighten it firmly, but not over tightened, or they will strip.  
 螺絲鎖入塑膠件請務必注意，適當扭力鎖緊即可，而過緊的扭力可能會導致滑牙。

For original factory package, if the product is already assembled by Factory, please check again if screws are firmly secured and applied with some glue.  
 原廠零件出廠包裝如果是組裝品，請再確認各螺絲是否鎖緊上膠。