

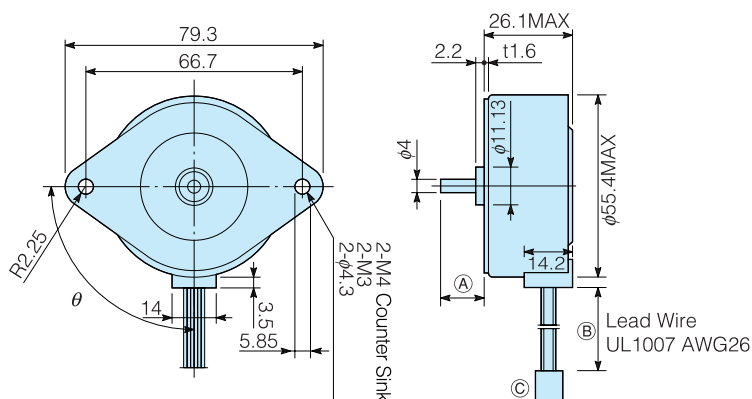

Standard Dimensions(mm)



Shaft Length(mm)	Ⓐ	11	15	18
Lead Wire Length(mm)	Ⓑ	150±10	250±10	350±10
Connector	Ⓒ	Connector type available		

Typical Data

Model	Rated Input (W)	Resistance (Ω /Phase)		Step Angle (DEG)	Rotor Inertia (g·cm ²)		Weight (g)	Magnet Type
		Ω	mH		Y	N		
55SPM25D5	4	6.5	6.3	7.5	62	41	240	Blanked (Isotropic ferrite)
55SPM25D7		12	11					Y (Radial anisotropic ferrite)
55SPM25DA		36	32					N (Nd-Fe-B)
55SPM25DC		50	50					

Characteristics

A. Constant Voltage Driving

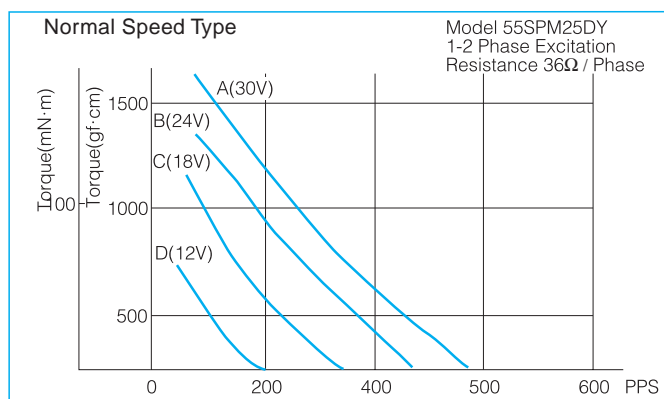
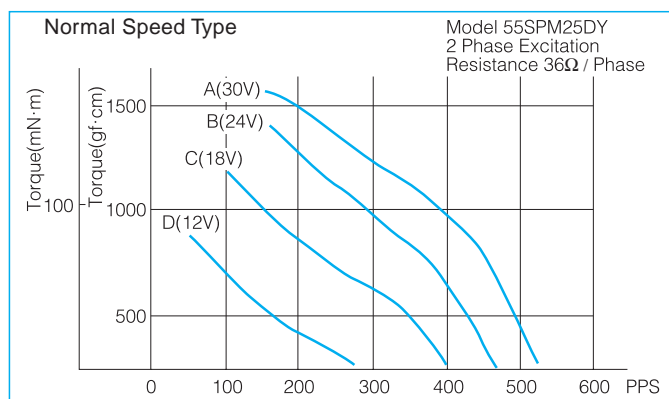
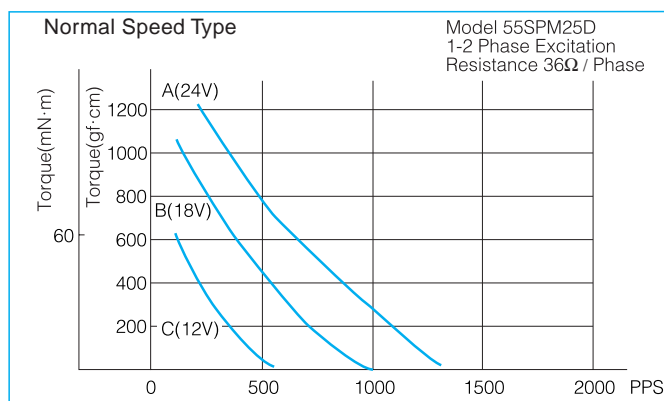
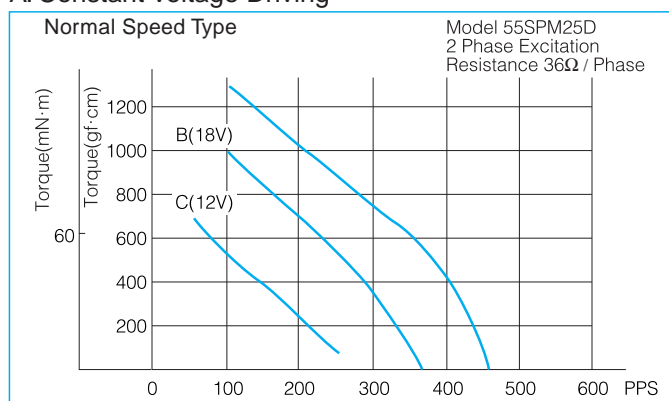

Characteristics

B. Constant Current Driving

